

# PRODUCT OVERVIEW

## HTH Tilting Dividing Heads

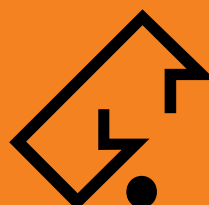

WERKZEUGSYSTEME  
MÜLLER GMBH  
**HOFMANN**  
MESS- UND TEILTECHNIK

# Technical data of HTH Tilting Dividing Heads

## Main characteristics

- Manual, tilting dividing head with centre heights of 100 mm for direct and indirect positioning of workpieces on machine tools.
- The worm gear is set to a low amount of backlash and enables the turning axis to be positioned manually with an indexing plate device. The standard indexing plate has 10 indexing circles on each side with the hole counts 13, 15, 16, 17, 18, 19, 20, 21, 23, 24, 27, 29, 31, 33, 37, 39, 41, 43, 47 and 49.
- Eccentric worm shaft bearing to compensate the backlash in the worm gear, or for swivelling out for direct indexing work.
- If the worm gear is swivelled out, direct indexing can be carried out at the indexing spindle with direct indexing plate and notch lever. The direct indexing plate is located protected at the rear end of the indexing spindle, and has 24 notches for indexing 2, 3, 4, 6, 8, 12 and 24 positions.
- Indexing spindle with MT (Morse taper) hole and external short taper to enable workpiece clamping systems to be replaced quickly.
- Compact, space-saving design with high rigidity in both axes.
- The turning and tilting axes are clamped to achieve a high machining performance. The turning axis is clamped by a manually operated hydraulic clamp and the swivel axis to both tension brackets at the trunnions.
- Housing parts are painted with structured coating RAL 7035 Light Grey.

## Accuracies

Size		100
Tilt range with 1° reading value	(°)	0° bis 90°
Worm gear ratio	(i)	40:1
Indexing accuracy	(sec)	±60"
Circular runout of internal and external spindle taper	(mm)	0.01
Axial runout of indexing spindle face	(mm)	0.01

## Load and performance data

Size		100
Load capacity for horizontal axis max.	(kg)	50
Load capacity for horizontal axis with tailstock max.	(kg)	100
Load capacity for vertical axis max.	(kg)	50
Axial force max.	(kN)	10
Radial force max.	(kN)	5
Tilting moment	(Nm)	75
Tilting moment indexing spindle clamped	(Nm)	160



## Dimensions

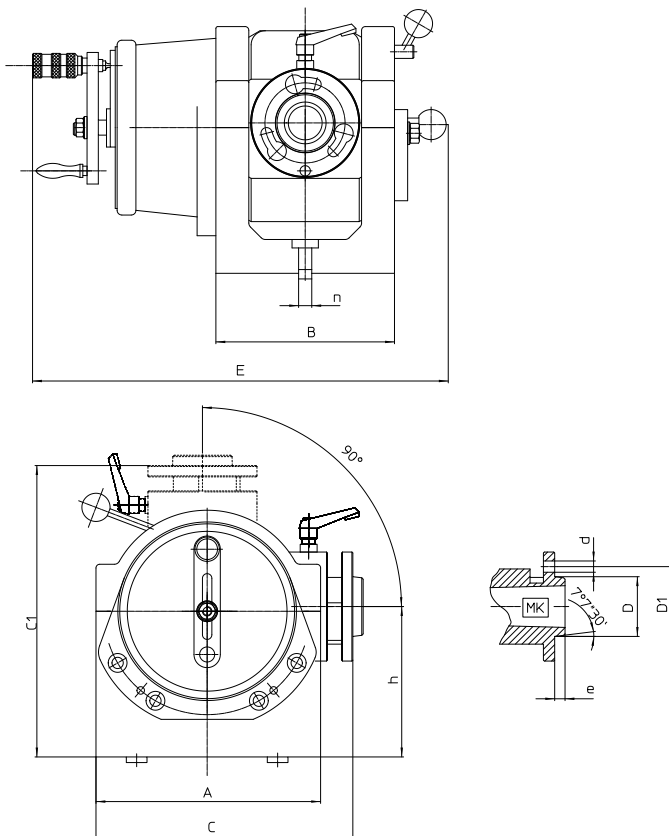

Size		100
A	(mm)	160
B	(mm)	140
C	(mm)	197
C1	(mm)	197
d		8.5
D1 <sup>H7</sup>	(mm)	49
D <sub>h6</sub>	(mm)	36
e	(mm)	10
E	(mm)	350
h	(mm)	100
MK	(mm)	3
n	(mm)	14
Weight	(kg)	25

## HTH accessories

- Rigid, manually operated tailstocks, also with MT tailstock sleeve
- Moveable tailstock with fixed tailstock centre
- Manual three-jaw chuck with flange to be attached to the indexing spindle
- Manual collet chuck with through bore or MK retainers to be attached to the indexing spindle for standard collets
- Centre and carrier to be attached to the indexing spindle
- Steady rest for longer workpieces
- Raiser plate set for dividing head and tailstock for increasing the centre height
- Additional direct indexing plates with 2 to 36 notches; can be replaced with the standard direct indexing plate
- The additional direct indexing plate for the indexing plate device has ten indexing circles on each side with the hole numbers 51, 53, 57, 59, 61, 63, 67, 69, 71, 73, 77, 79, 81, 83, 87, 89, 91, 93, 97 and 99.
- Hand wheel with micrometer dial, also suitable for uneven indexing, can be replaced by the hole plate attachment.





Hofmann Mess- und Teiltechnik is part of the renowned Müller group, a successful alliance of five companies, which offers great synergistic effects to their customers.

Having more than 80 years of experience combined with fresh creativity and innovational strength, Hofmann is a well sought-after partner by renowned manufacturers of machine tools for processing metal. Our efficient and customized solutions are produced by qualified specialists in our state-of-the-art machine shop in Pliezhausen near Stuttgart. Fast, cost-saving and specially designed for the needs of our customers.

**Invest in the technology of the brand name HOFMANN.  
You will benefit from it!**



**WERKZEUGSYSTEME  
MÜLLER GMBH  
HOFMANN  
MESS- UND TEILTECHNIK**

**Werkzeugsysteme Müller GmbH  
Hofmann Mess- und Teiltechnik**

Robert-Bosch-Straße 5 | 72124 Pliezhausen  
Phone: +49 7127/973-130 | Fax: +49 7127/973-015  
Email: [info@hofmann-mt.de](mailto:info@hofmann-mt.de) | [www.hofmann-mt.de](http://www.hofmann-mt.de)